

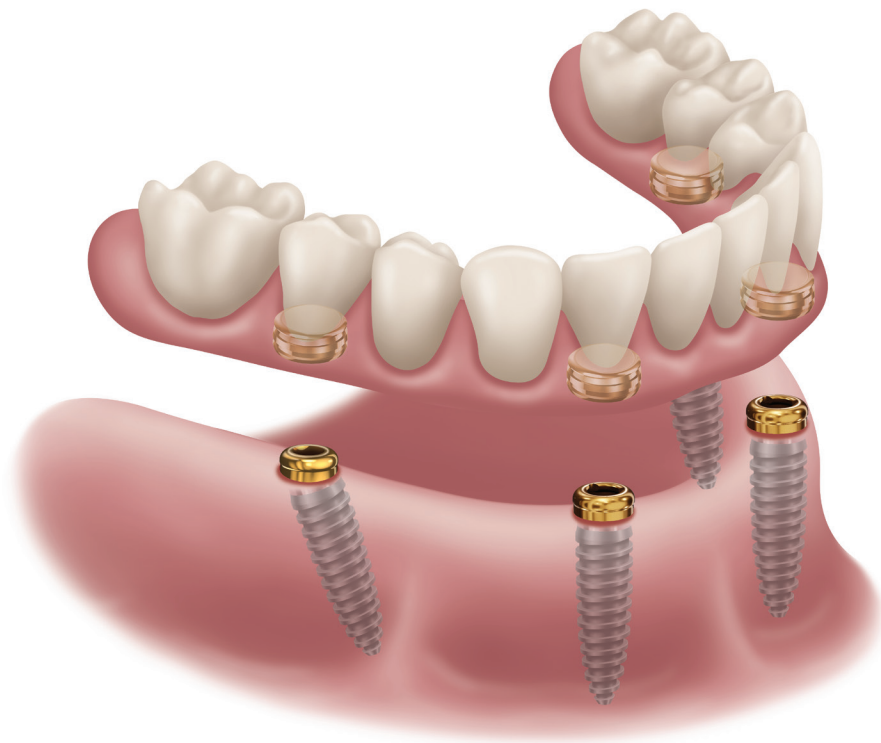

LOCATOR[®]

ANGLED ABUTMENT



LOCATOR[®] ANGLED

TECHNIQUE MANUAL

TABLE OF CONTENTS

THE LOCATOR® ANGLED COMPONENT REFERENCE LIST	3
THE LOCATOR® ANGLED COMPONENT ORDER GUIDE	4
LOCATOR®-THE GOLD STANDARD ATTACHMENT SYSTEM.....	5
LOCATOR®- A FAMILY OF SOLUTIONS.....	6
LOCATOR® ENHANCED CORE TOOL	7
PLACING THE LOCATOR® ANGLED ABUTMENT.....	8
REMOVAL OF THE LOCATOR® ANGLED ABUTMENT	11
RESTORATION INSERTION, REMOVAL AND CLEANING GUIDELINES.....	14
RETURN POLICY AND WARRANTY.....	15

PLEASE NOTE: This document is designed to serve as a guide for dental clinicians using Zest Dental Solutions® Products. It is not intended to be a substitute for professional training and experience. Please refer to the Instructions For Use for further information.

THE LOCATOR® ANGLED COMPONENT REFERENCE LIST

LOCATOR ANGLED ABUTMENTS

IMPLANT ABUTMENTS

2.5 mm cuff



3.5 mm cuff



4.5mm cuff



5.5mm cuff



6.5mm cuff



7.5mm cuff



REFER TO PAGE 4 FOR ALL AVAILABLE CONNECTIONS

LAB PROCESSING

Impression Coping
08505



Abutment Analog
08530 4mm
08516 5mm



Black Processing Male
08515

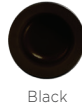

Black

Block-Out Spacer
08514



White

Processing Spacer
08569



Parallel Post
08517



LOCATOR Removable Housing
08510



LOCATOR FIXED Housing
09508



REPLACEMENT MALES

LOCATOR FIXED INSERTS

4 Implant Insert
09501

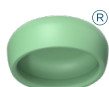

Green

Anterior/Posterior Insert
09506

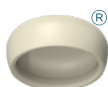

Tan

Mid Arch Insert
09507

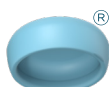

Blue

LOCATOR REMOVABLE INSERTS

(ANGLED LOCATOR ABUTMENTS ARE ONLY COMPATIBLE WITH EXTENDED RANGE REMOVABLE INSERTS)

Zero Retention Male
08558



Gray

Extra Light Retention Male
08548



Red

Light Retention Male
08915



Orange

Regular Retention Male
08547



Green

TOOLING

LOCATOR Enhanced Core Tool
08340



Driver for Angled Abutments
02405



NOTE: Driver comes with Short and Long Driver Insert

Abutment Removal Screw, M1.6 Thread
(Nobel NP, Straumann BLX)
02412



Abutment Removal Tool, M2.0 Thread
(Nobel RP)
02413



LOCATOR® ANGLED ABUTMENT ORDER GUIDE

CONNECTION	PART NUMBER	CUFF HEIGHT	REPLACEMENT SCREW	REMOVAL TOOL
Nobel NP	02415-SB	2.5mm	02414-SB	02412-SB
	02416-SB	3.5mm		
	02417-SB	4.5mm		
	02418-SB	5.5mm		
	02419-SB	6.5mm		
	02420-SB	7.5mm		
Nobel RP	02422-SB	2.5mm	02421-SB	02413-SB
	02423-SB	3.5mm		
	02424-SB	4.5mm		
	02425-SB	5.5mm		
	02426-SB	6.5mm		
	02427-SB	7.5mm		
ZimVie TSV 3.5	02429-SB	2.5mm	02428-SB	N/A
	02430-SB	3.5mm		
	02431-SB	4.5mm		
	02432-SB	5.5mm		
	02433-SB	6.5mm		
	02434-SB	7.5mm		
ZimVie TSV 4.5	02435-SB	2.5mm	02428-SB	N/A
	02436-SB	3.5mm		
	02437-SB	4.5mm		
	02438-SB	5.5mm		
	02439-SB	6.5mm		
	02440-SB	7.5mm		
Neodent GM	02442-SB	2.5mm	02441-SB	N/A
	02443-SB	3.5mm		
	02444-SB	4.5mm		
	02445-SB	5.5mm		
	02446-SB	6.5mm		
	02447-SB	7.5mm		
Straumann BLX	02398A-SB	2.5mm	02404-SB	02412-SB
	02399A-SB	3.5mm		
	02400A-SB	4.5mm		
	02401A-SB	5.5mm		
	02402A-SB	6.5mm		
	02403A-SB	7.5mm		

LOCATOR® - THE GOLD STANDARD ATTACHMENT SYSTEM

THE BEST JUST GOT BETTER

For 40 years, Zest Dental Solutions® has been a global leader in the design, development, manufacturing and distribution of dental solutions for edentulous patients. The company pioneered pivoting, self-aligning attachments that substantially reduced the damage caused by the improper seating of overdentures. Zest Dental Solutions is located in Carlsbad, California with global distribution through implant companies, distributor networks, and its own domestic retail sales operation.

Today, Zest's flagship product, LOCATOR, is recognized as an industry wide solution for implant-retained, tissue supported removable overdentures and for implant supported FIXED prostheses with LOCATOR FIXED. Over the years, Zest has continued to improve and innovate the options for edentulous patients. Today, the LOCATOR abutment that clinicians all around the world have come to know and trust can now be used for removable OR fixed patient solutions with increased angle correction.

The new LOCATOR Angled abutment provides 15 degrees of implant angulation correction and the system can restore up to an additional 20 degrees with the use of extended range or FIXED inserts..

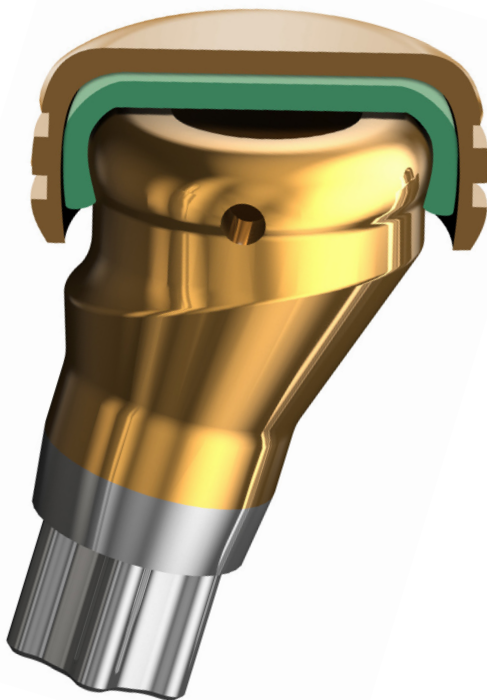

ANGLED ABUTMENT WITH
LOCATOR FIXED HOUSING
AND INSERT

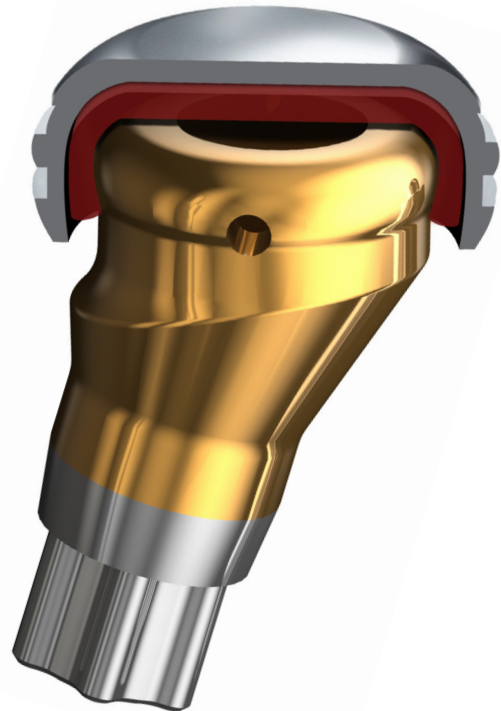

ANGLED ABUTMENT WITH
LOCATOR REMOVABLE
HOUSING AND INSERT

LOCATOR® - A FAMILY OF SOLUTIONS

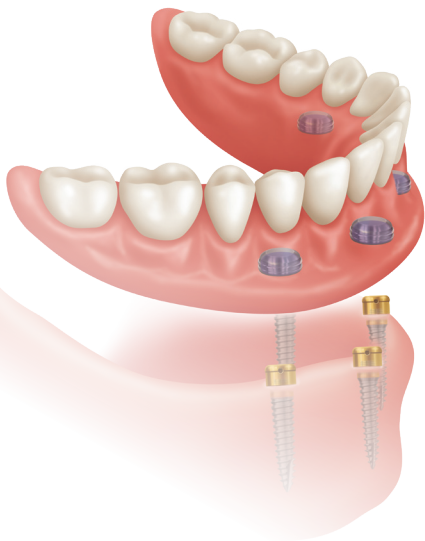

IMPLANT ATTACHMENT

The LOCATOR Attachment with patented pivoting technology is the premier system for implant-retained overdentures and now FIXED prostheses. According to recent studies, a two implant-retained, tissue-supported overdenture restoration is considered the new minimum standard of care for edentulous patients. More than two implants may also be placed for more stability and improved patient satisfaction.

LOCATOR attachments are now available in pre-angled designs offering even more flexibility in case planning and implant placement.

BAR ATTACHMENT

When a case calls for an overdenture bar, the LOCATOR Bar Attachment provides the same pivoting technology, self-aligning feature, superb retention, and exceptional durability, all in a low-profile design. It also offers three options for the fabrication of a resilient attachment on an implant-supported cast alloy or milled titanium bar.

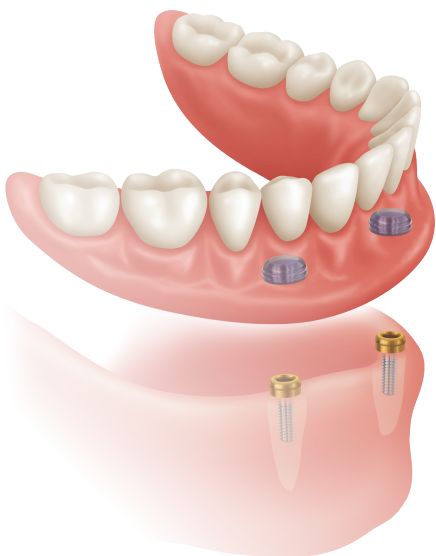
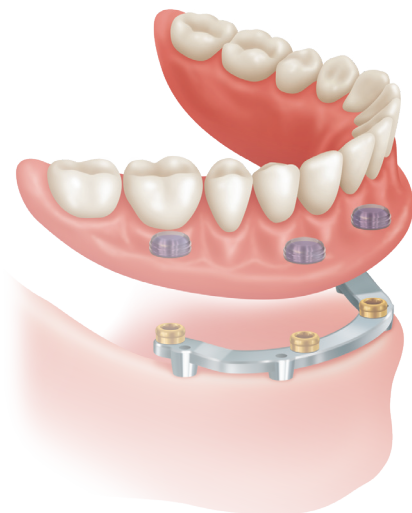

ROOT ATTACHMENT

In clinical situations where healthy tooth roots can be prepared for placement of attachments to retain an overdenture, the LOCATOR Root Attachment delivers great versatility. Its supra-radicular design gives you the choice of a straight post, 10° and 20° angles to accommodate divergent roots, as well as a special cast-to version.

LOCATOR FIXED

The first abutment that can be used for removable or fixed solutions with only the change of an insert! LOCATOR FIXED offers patients an affordable path to a fixed solution, while offering clinicians a familiar workflow and product they already know and trust.

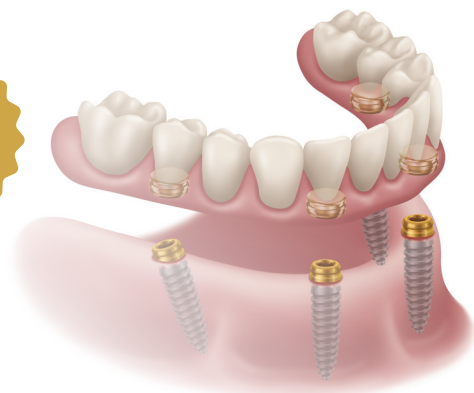

LOCATOR® ENHANCED CORE TOOL

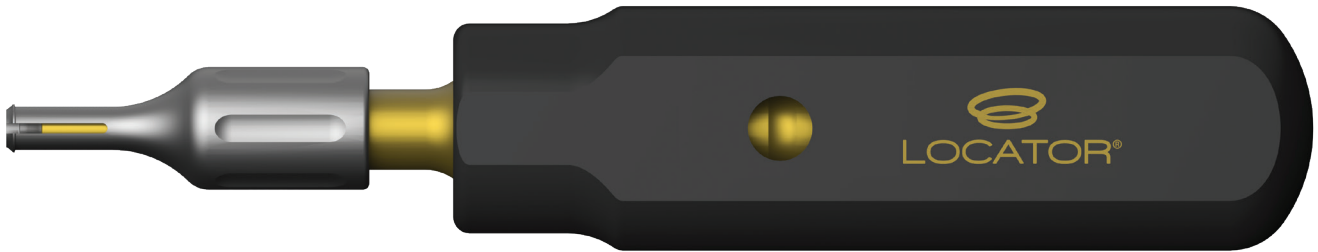

ENHANCED CORE TOOL FOR LOCATOR AND LOCATOR FIXED

- One streamlined tool compatible with LOCATOR Removable and LOCATOR FIXED Inserts
- Two-sided instrument designed for easy insertion and removal of any LOCATOR Insert
 - **Insertion Tip:** Effortlessly pickup inserts for transfer and placement in housing
 - **Removal Tip:** Place tip with closed prongs into insert, twist collet to open prongs, tilt core tool and easily remove LOCATOR Insert

LOCATOR® ANGLED ABUTMENT

PLACING LOCATOR ANGLED ABUTMENTS

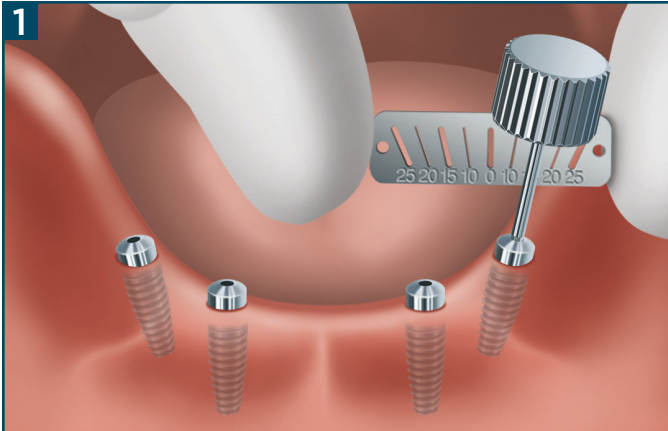

1 Use the Angle Measurement Guide to determine the angulation of each implant. LOCATOR Angled abutments correct 15° of implant angulation. The Extended Range Inserts can restore up to an additional 20° of angulation.

NOTE: LOCATOR Angled Abutments are only compatible with LOCATOR FIXED and LOCATOR Removable Extended Range Inserts.

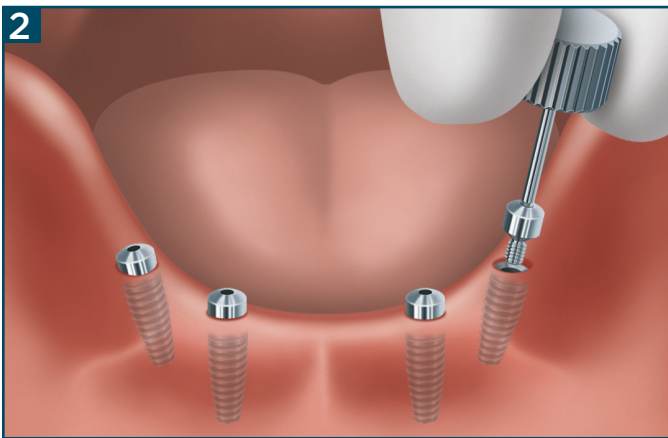

2 Identify the system and diameter of each implant. Remove the healing abutments.

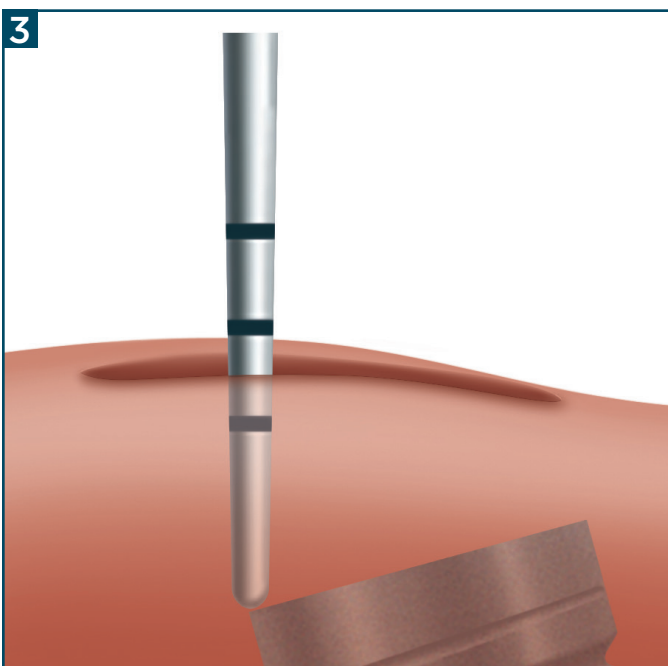

3 Using a periodontal probe, measure the height of the gingiva at the highest point and select the cuff height of the Angled LOCATOR Abutment that corresponds to that measurement. If it is 2.5mm, choose a 2.5mm cuff height. An additional 1.5mm of Abutment height will extend above the gingiva to accommodate for the Denture Housing.

TIP: If tissue height is between cuff heights go down for LOCATOR Removable and up for LOCATOR FIXED.

LOCATOR® ANGLED ABUTMENT



4 Using the abutment driver and thumb knob, or 0.050" / 1.25mm Hex Driver, insert and press the driver firmly into the abutment screw until the abutment is captured onto the driver.

NOTE: Some connections will have an internal abutment screw packaged separately from the abutment. In these cases use care to deliver the abutment to the mouth as the abutment screw will be delivered separately.

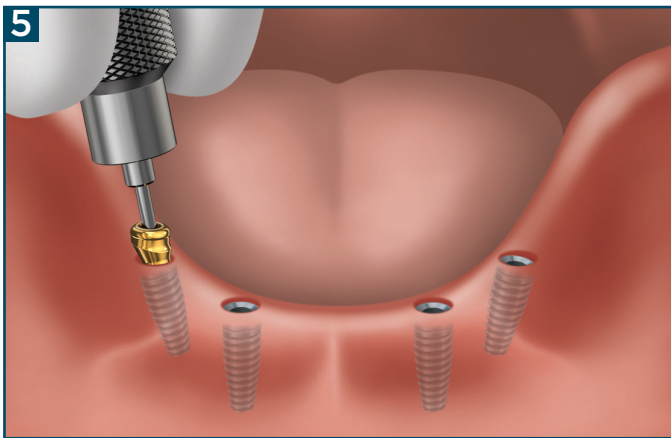

5 Transfer the abutment to the implant site and insert the abutment into the implant at the desired abutment orientation.

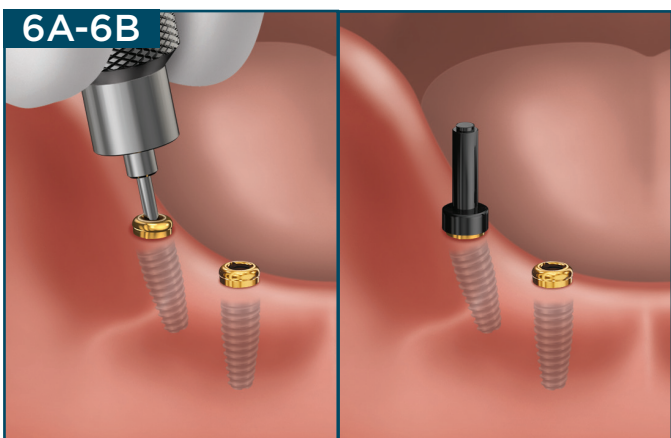

6A-6B Preliminarily hand-tighten the abutment into place, confirm that the desired abutment orientation is obtained visually using the provided parallel post.

NOTE: If the abutment screw was packaged separately you will need to insert it into the abutment before starting this step.

TIP: If the abutment orientation needs to be adjusted, reposition the abutment into the desired abutment orientation prior to tightening the screw.

LOCATOR® ANGLED ABUTMENT

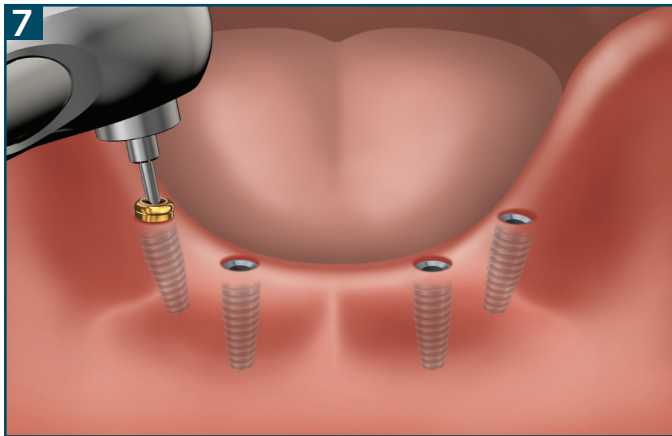

7 Using the torque wrench and the angled abutment driver, tighten the angled abutment to 30 Ncm or to the torque for an abutment screw recommended by the manufacturer of the implant/abutment system. Use of higher torque values than recommended above could cause a fracture of the angled abutment or screw.

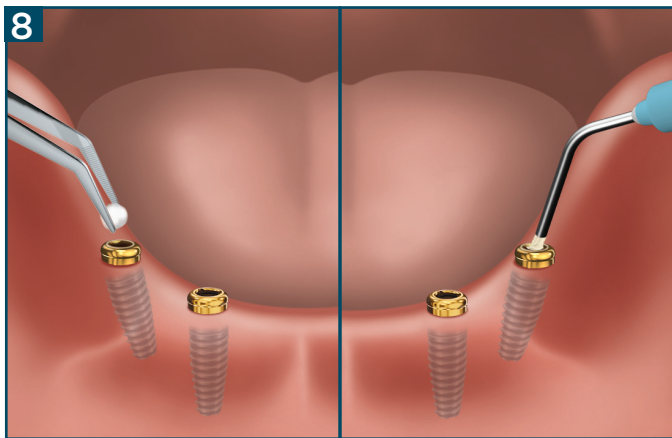

8 Seal top of abutment with a small pellet of polytetrafluoroethylene (PTFE) or sterile cotton covering the internal screw followed by a bulk-filled composite such as Bulk-EZ Plus® or material of choice. For optimal performance, ensure PTFE/cotton is well-condensed and composite material does not overfill past the top of the abutment.

NOTE: This step is not necessary for straight LOCATOR Abutments.

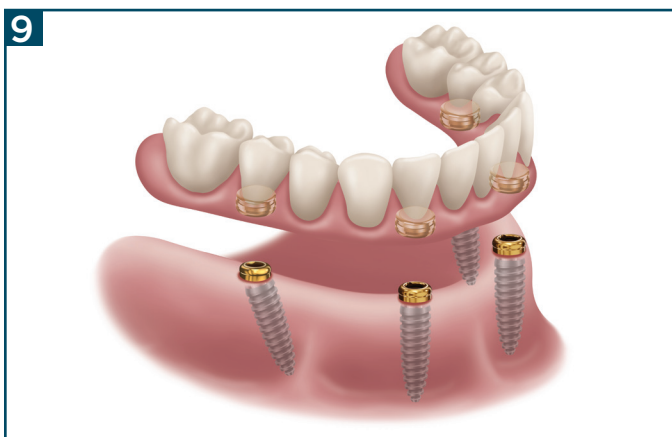

9 Refer to the LOCATOR abutment manual (L8030-TM) for restorative techniques. LOCATOR Angled abutments use standard LOCATOR protocols for pickups.

NOTE: LOCATOR Angled Abutments are only compatible with LOCATOR FIXED and LOCATOR Removable Extended Range Inserts. LOCATOR Removable Standard Range inserts are not compatible with Angled Abutments.

LOCATOR® ANGLED ABUTMENT

REMOVAL OF THE LOCATOR ANGLED ABUTMENT

IMPORTANT: Protective mechanisms such as a throat pack or airway sponge are recommended to prevent aspiration of instruments, screws, or abutments during removal steps.

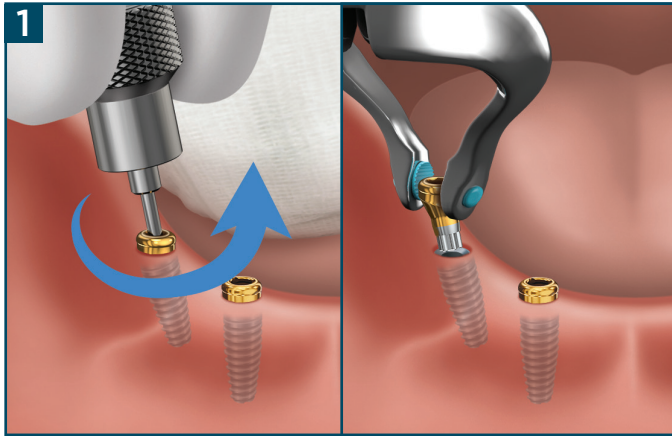

1 To remove the abutment from the implant, begin by carefully removing any material sealing the top of the abutment using manual instruments such as a curette or a dental handpiece with a bur such as a #330 or small round, avoiding contact with the abutment walls or internal screw. Next, insert the torque wrench and the angled abutment driver firmly into the abutment screw. Apply a counterclockwise force on the screw until the abutment screw is no longer engaged with the implant. At this point, you may be able to remove the abutment from the implant by hand or use a padded hemostat with a gentle rocking motion. If you cannot remove the abutment move to the next step.

STEPS 2 AND 3 will not be required for **TSV** or **Neodent GM connections**

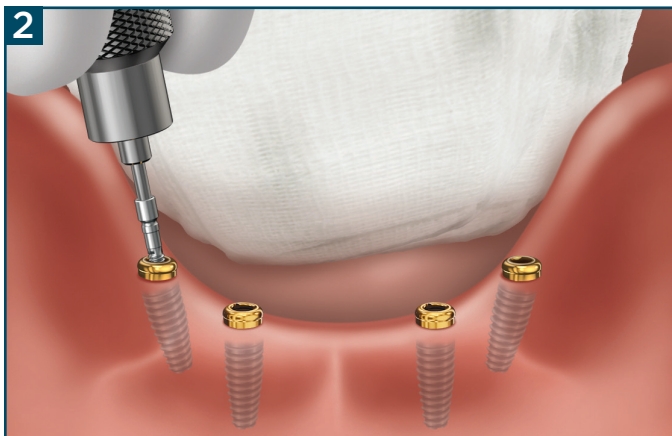

2 If you are unable to remove the abutment from the implant, remove the abutment screw from the abutment by doing the following. Insert and press the driver firmly into the abutment screw using the thumb knob. Pull up on the abutment driver and thumb knob and continue to apply a counterclockwise torque until the abutment screw is fully removed from the implant and abutment.

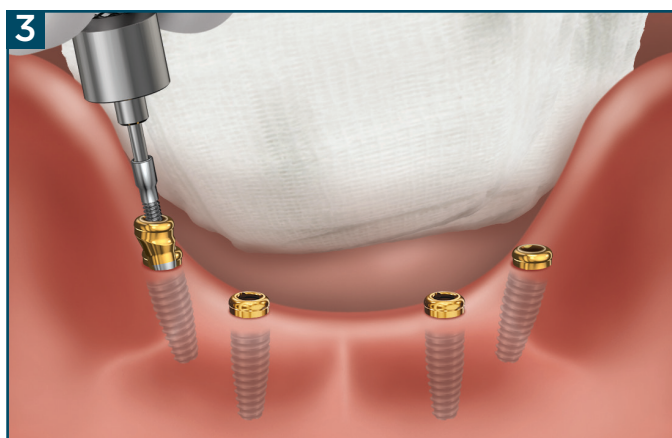

3 With the abutment screw removed, attach the Abutment Removal Tool to the Angled Abutment driver and insert it into the abutment until the Abutment Removal Tool bottoms out. Apply a clockwise torque to the Abutment Removal Tool until the abutment disengages from the implant. By holding the abutment removal tool, remove the abutment from the implant.

NOTES

Lined area for notes, consisting of approximately 30 horizontal lines.

RESTORATION INSERTION, REMOVAL AND CLEANING GUIDELINES FOR THE CLINICIAN AND PATIENT

To maintain the LOCATOR® Abutments and fixed or removable restorations, it is critical that clinicians and patients perform routine maintenance. Inspect abutment for wear at each hygiene appointment, replace if gold surface is wearing away. A worn abutment may affect the retention and fit of the insert to the abutment.

It is also important that patients understand the proper hygiene routines that should be performed at home. Zest recommends the Regal Hygiene Solutions system. This is a 2-step solution that is used in office and at home. Find out more at www.zestdent.com.

Refer to the LOCATOR FIXED manual for recommendations for maintaining FIXED restorations with LOCATOR Abutments. Refer to the LOCATOR Removable Technique Manual for recommendations for maintaining removable restorations with LOCATOR Abutments.

ADDITIONAL NOTES OF CAUTION

Failure of the patient to follow oral hygiene protocols and appropriately care for the restoration may also result in inflamed tissue around the implant, leading to the development of peri-implantitis. Throughout time, peri-implantitis may cause the implant to become mobile and fail. Please ask patients to consider the following when caring for their restorations:

Avoid using abrasive toothpaste to clean the restoration. The coarse particles in the toothpaste may scratch the surfaces of the restoration, enhancing the potential for plaque accumulation.

Oral rinse such as Listerine® mouthwash can be used safely without any negative effect on the Abutments or Replacement Insert.

RETURN POLICY AND WARRANTY

ORDERING

Orders are accepted by internet, email, mail, fax, or phone. Regular business hours are 5:00am to 5:00pm PST (Pacific Standard Time). Domestic orders received by 1:00pm PST can be shipped by ground the same day. Orders received by 3:00pm PST can be shipped by express. Institutional orders require a purchase order number.

PRICING

Zest Dental Solutions® makes every effort to maintain a competitive pricing structure. Pricing is subject to routine review and change without prior notice. All prices listed are in U.S. dollars.

TERMS AND BILLING

A. Credit Card: Payment at the time of order with VISA, AMERICAN EXPRESS, DISCOVER or MASTERCARD is necessary for customers not approved for open account billing or special financing offers.

B. C.O.D.: Delivery can also be made by C.O.D. freight collect.

C. Open Account: An open account can be established by completing a credit application and receiving approval by Zest Dental Solutions. The terms of orders purchased under open accounts are net 30 days.

D. Export Orders: Individual orders shipped outside the U.S. require payment in advance or a letter of credit.

E. Past Due Accounts: Past due balances will be subject to a 1.5% finance charge per month, amount equal to 18% per annum.

SHIPPING CHARGES

Merchandise is shipped prepaid by Zest Dental Solutions with the cost added to the invoice, or freight collect with C.O.D. fee included in the case of C.O.D. shipments. Delivery options include Fed Ex ground, 3-day, 2-day, or overnight rush service.

LIMITED WARRANTY

Zest Dental Solutions provides a limited warranty for its products, to the original purchaser, to be free from defects in workmanship and materials under normal use and service, for a period of one year from the date of purchase, with the exception of LOCATOR and

LOCATOR R-Tx abutments which carry a 4 year limited warranty when purchased directly from Zest Dental Solutions, and a 2 year limited warranty when purchased from one of our partners.

Zest Dental Solutions will, at its option, substitute the returned product that proves defective within the warranty period, with a similar product, free of charge. Zest Dental Solutions continually strives to improve its products, and therefore, reserves the right to improve, modify, or discontinue products at any time without notice or incurring obligations. Purchaser assumes all risks and liability resulting from the use of Zest Dental Solutions Products, whether used separately or in combination with other products not of Zest Dental Solutions manufacture.

RETURN POLICY

Please Observe the Following Guidelines:

- A.** Authorization for returns must be received from Zest Dental Solutions prior to the return of any product. A Return Material Authorization (RMA) number will be provided for all returns.
- B.** Shipping charges must be prepaid by the customer to accept a return shipment.
- C.** Returned products are subject to a \$20 restocking fee for orders under \$400. For orders \$400 to \$1,000, a \$40 restocking fee will be applied. For orders exceeding \$1,000, please contact your Customer Service Representative for the restocking fee.
- D.** Returned merchandise will be accepted within 90 days of purchase if product is in saleable condition (in its original unopened package and not marred by any added writing or over-labeling).
- E.** Returns will not be accepted after 90 days of purchase.
- F.** Non-returnable items include:
 - 1. Merchandise retained beyond expiration date noted on the package.
 - 2. Packages with broken seals or missing parts
 - 3. Used, damaged, or obsolete products will not be accepted for return.
- G.** Order discrepancies must be reported within 30 days of invoice date.

VISIT OUR WEBSITE AT
WWW.ZESTDENT.COM
TO PLACE ORDERS ONLINE
24 HOURS A DAY 7 DAYS A WEEK

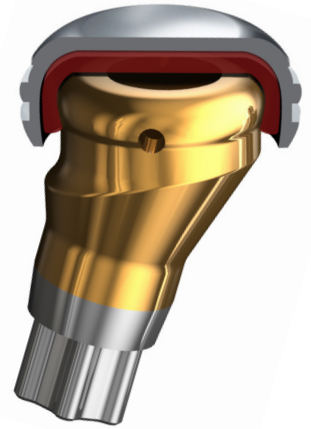

ZEST DENTAL SOLUTIONS
2875 LOKER AVENUE EAST
CARLSBAD, CA 92010
USA

TEL: 1.855.866.LODI (5934)
FAX: 760.743.7975
EMAIL: SALES@ZESTDENT.COM
WWW.ZESTDENT.COM